

LC200 CaptureVision System

Lumens[®]
Your Success...Our Passion!

Lumens CaptureVision System LC200 is an innovative media processor that allows you to record and create live streaming by mixing, encoding, and switching up to 4 HDMI or 3 IP video sources, and 4 audio sources. The LC200 can backup video files to a content management server or stream to most cloud video servers. It is applicable for use in education, corporate, government, healthcare, house of worship, and other applications.

Key Features

- Supports 1080p 60/30fps recording.
- Supports 4 HDMI Inputs and IP video sources including Lumens IP Cameras, NDI|HX Camera, and standard RTSP streams.
- Flexible scaling and window processing, supports PIP, PBP and up to 4 windows layout and mixing.
- Advanced Scenes Switch.
- Supports HDMI-embedded audio or analog stereo audio with 4 channels Audio Input mixing and gain control.
- Built-in 1TB HDD storage.



Product Interface

■ Front Side View

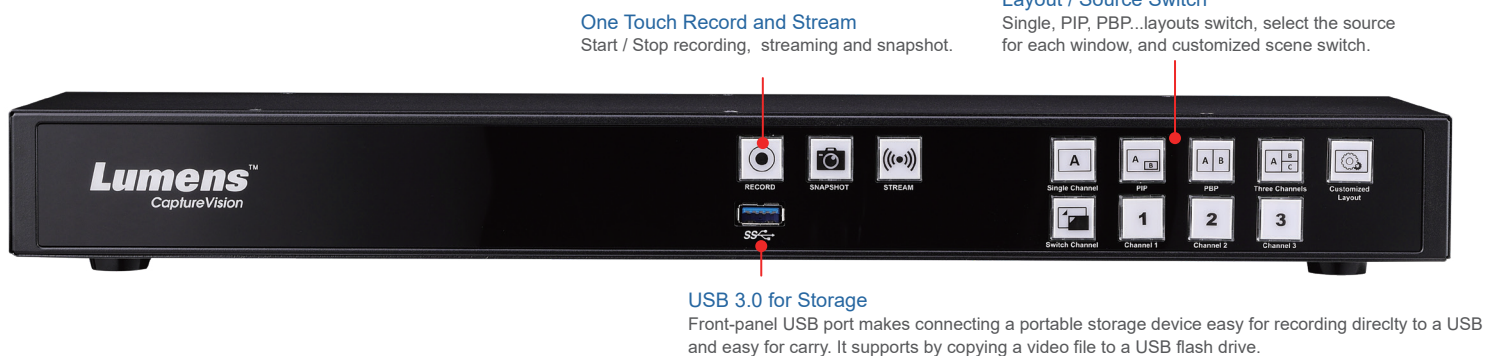

■ Back Side View

Analog stereo audio Input

Supports 4 analog stereo audio (3.5 mm phone jack) for line in and MIC in.

Line Out

3.5mm phone jack line out for live audio mix monitoring.

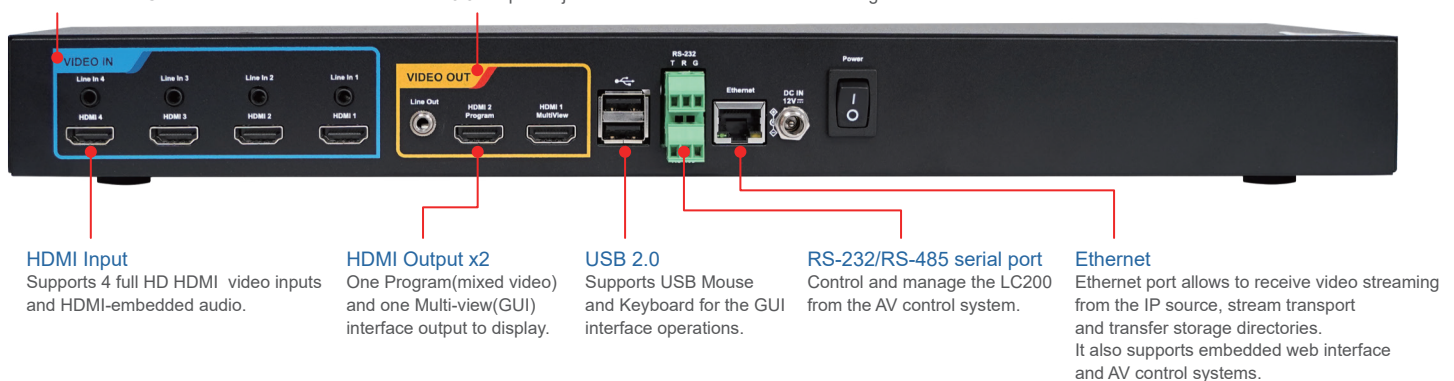

Live Streaming Diagram Example

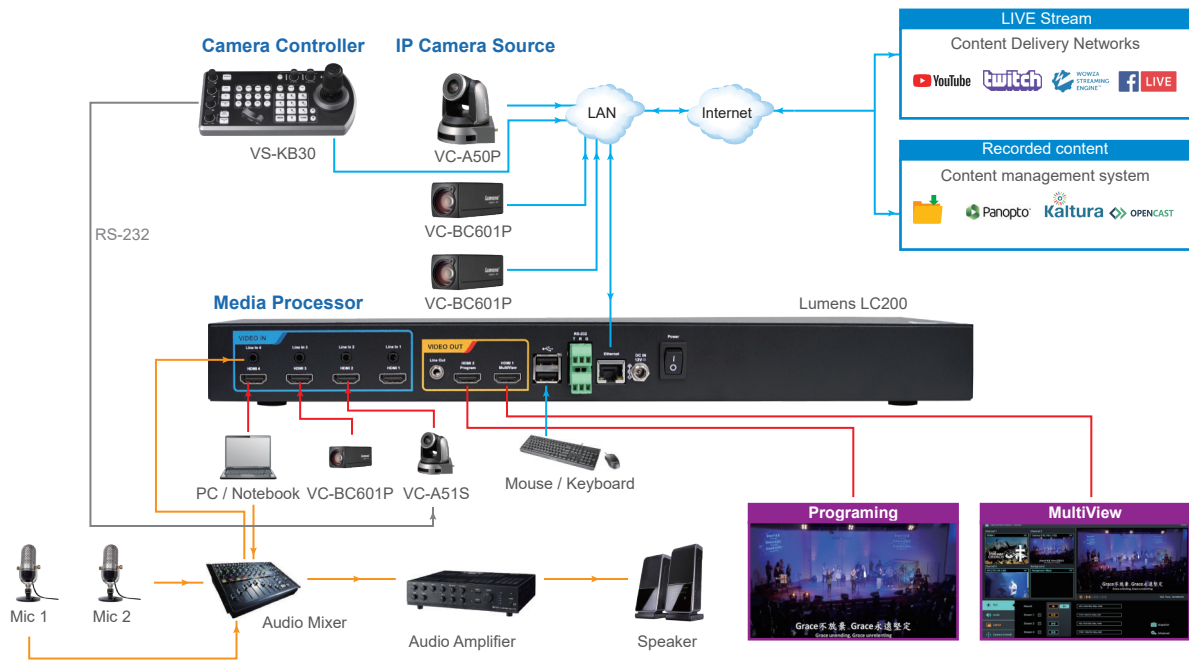

Product Specifications

INPUT	
Number/signal	4 HDMI digital video
Connection	4 female HDMI type-A
IP Source	Lumens IP PTZ / Box Camera Lumens NDI HX Camera RTSP Source (H.264 1080p 60 / 30fps)
VIDEO PROCESSING	
Video Compression	H.264 / AVC 4:2:0 8bit color Encoding profile: High, Main, Baseline
Bitrate	200 kbps to 10 Mbps
VIDEO OUTPUT	
Number/signal	3 H.264 / AVC digital video over Ethernet 2 HDMI digital video
Scaled resolution	1080p
Frame rate	30 / 60 fps
RECORDING AND STORAGE	
Internal storage	1TB HDD
External Storage	1 USB 3.0 port in front panel
File Type	H.264 and AAC in an MP4 container, JPEG
Resolution	480p, 720p, 1080p
Frame rate	Max. 1080p 60 / 30 fps
AUDIO INPUT	
Number/signal	4 Line In/MIC In (stereo, 3.5mm phone jack) 4 stereo, digital de-embedded audio from HDMI

AUDIO PROCESSING	
Compression	AAC-LC
AUDIO OUTPUT	
Number/signal	1 stereo, unbalanced 3.5mm phone jack 2 stereo, digital de-embedded audio from HDMI
COMMUNICATION	
USB	2 rear panel USB 2.0 type A Supports USB mouse, keyboard
Serial control	RS-232/RS-485 port
Ethernet	
Ethernet host port	1 female RJ-45 10/100/1000 Base-T high/full duplex
Streaming Protocol	Pull: RTSP Push: RTMP / RTMPS TCP, UDP, HTTP HDCP Client
GENERAL	
Power supply	DC In , 12V / 2A
Power consumption	24W
Dimensions	Standard 1u rack dimensions 122.5mm(L) x 431mm (W) x 44.3mm (H)
Weight	1.2 Kg

Lumens[®]
Your Success...Our Passion!

www.MyLumens.com

Lumens Integration, Inc.
4116 Clipper Court
Fremont, CA, 94538
Phone : 888.542.3235
Fax : 510.252.1389

Lumens Europe
De Nayerstraat 17 9470
Denderleeuw Belgium
Phone : +32 473 58 38 95
Fax : +32 (0) 2 452 76 00

